

H SERIES

GEAR PUMPS



DESIGNED FOR VERSATILITY

All cast iron gear pump for those low to medium flow systems. Small package size makes it ideal for direct mounting to PTOs. SAE shaft and flanges. Both side and rear ports standard.



KEY FEATURES

- 6 standard sizes
- Pressures to 3,500 PSI (240 Bar)
- Speeds to 4,000 RPM
- All cast iron construction
- NPT or SAE O-Ring ports
- Full one year warranty
- Solid one piece shaft
- Pressure balanced wear plates
- Dowel pin construction
- Long life sleeve type bushings

PUMP SPECIFICATIONS

MODEL NUMBER	DISPLACEMENT IN3 (CC)	MAX* RPM	MIN* RPM	MAX PRES PSI (BAR)	DIM A	DIM B	MAX OIL TEMP	MAX INLET VACUUM	WEIGHT LBS (KG)
PH1-03	0.62 (10.2)	4,000	1,000	3,500 (241)	7.37 [187.20]	0.90 [22.9]	200°F (93°C)	5IN.HG. (0.17BAR)	18 0(8.3)
PH1-05	1.24 (20.3)	4,000	800	3,500 (241)	7.87 [199.90]	1.40 [35.6]	200°F (93°C)	5IN.HG. (0.17BAR)	20 0(9.0)
PH1-07	1.55 (25.4)	3,600	800	3,500 (241)	8.12 [206.25]	1.65 [41.9]	200°F (93°C)	5IN.HG. (0.17BAR)	21 0(9.3)
PH1-08	1.86 (30.5)	3,600	800	3,250 (224)	8.37 [212.60]	1.90 [48.2]	200°F (93°C)	5IN.HG. (0.17BAR)	22 (10.1)
PH1-09	2.17 (35.6)	3,000	800	2,900 (200)	8.62 [218.95]	2.15 [54.6]	200°F (93°C)	5IN.HG. (0.17BAR)	24 (10.7)
PH1-11	2.48 (40.6)	3,000	800	2,500 (172)	8.86 [225.04]	2.40 [61.0]	200°F (93°C)	5IN.HG. (0.17BAR)	25 (11.3)

Note: Care must be made in selecting the proper pump size vs. the priority flow setting to prevent hydraulic energy loss and added heat load to the system.

DIRECT MOUNT DIMENSIONS

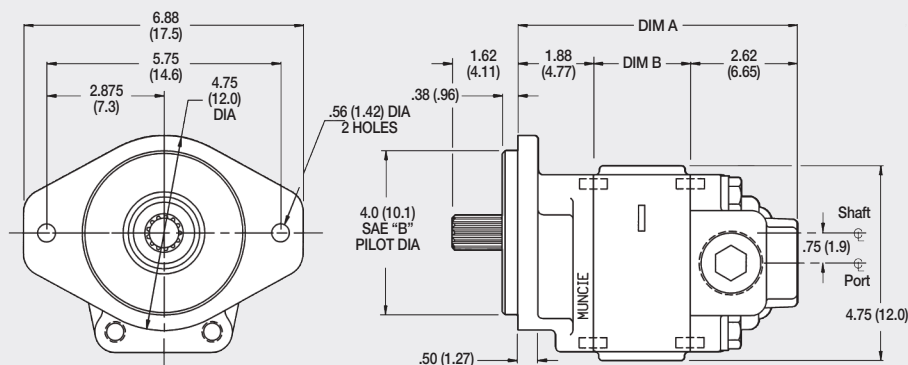

MODEL	DIM A IN (MM)	DIM B IN (MM)
PH1-03	4.77 (121.2)	0.90 (22.9)
PH1-05	5.24 (133.9)	1.40 (35.6)
PH1-07	5.52 (140.2)	1.65 (41.9)

MODEL	DIM A IN (MM)	DIM B IN (MM)
PH1-08	5.77 (146.5)	1.90 (48.2)
PH1-09	6.02 (152.9)	2.15 (54.6)
PH1-11	6.27 (159.3)	2.40 (61.0)

Note: SAE "B" pilot shown. SAE "A" pilot diameter is 3.25 (82.5), .44 diameter holes on 4.19 bolt circle.

MODEL NUMBER CONSTRUCTION

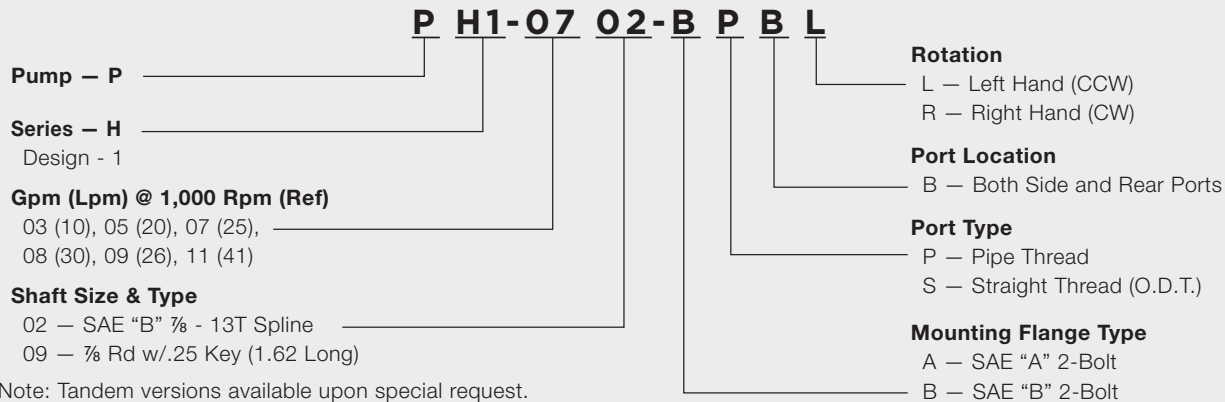

OIL RECOMMENDATIONS

Muncie does not promote specific manufacturers' brands of oil. Recommendations below are guidelines; consult oil manufacturer for exact application needs.

Viscosity Range:

- Viscosity Minimum: 50-60 SUS (7.5-10.5 cST)
- Viscosity Optimum Continuous: 60-100 SUS (10.5-21.6 cST)
- Viscosity Maximum @ Startup: 7500 SUS (1600 cST)
- Viscosity Index: 90 Minimum

Aniline Point: 175 Minimum

- Pour Point: 15°F (-10°C) Maximum
- Foam Resistance: Recommended
- Rust Resistance Inhibitors: Recommended
- Corrosion Resistance: Recommended
- Oxidation Stability: Recommended
- Anti-Wear Additive: .06% Zinc Minimum*

Note: Cold weather operation requires special oil considerations. Viscosity should not exceed 7500 SUS (1600 cST) at lowest startup temperature. Continuous operation should range between 60-1000 SUS (10.5-216 cST) for all temperature ranges. Never use diesel fuel or kerosene to thin oil.

*Anti-Wear Additives may be recommended by some motor manufacturers. However, they are optional and typically not required for gear pump or gear motors.