

# QUICKSTART

## T 12/1 + T 15/1



### Warning

These are only brief instructions! Please read and comply with these instructions prior to using or servicing your appliance.

The non-compliance of the operating and safety instructions may lead to damages of the appliance and to dangers for the operator and other persons.

## Start up

# 1



- A Insert the suction hose into the suction hose connection on the appliance.
- B Release and remove the suction head.
- C Check whether main filter basket has been inserted into the appliance.

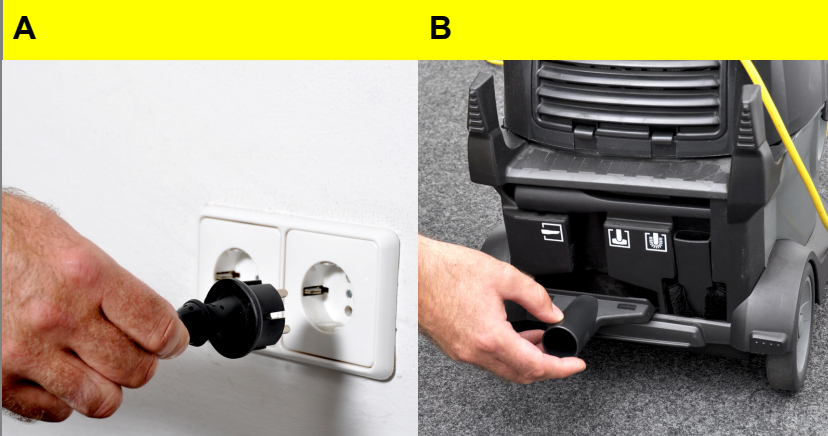

- A Plug in the main plug.
- B Integrated storage for accessories.

## Operation

# 2



- A Switch on the appliance at the main switch.
- B Set the selection switch of the floor nozzle to hard surface or carpet.
- C Perform the cleaning operation.
- D Regulate the suction force on the suction force regulator (continuous).

## Finish operation

# 3



- A Switch off the appliance at the main switch. Pull out the mains plug.
- B Depending on the storage room, the T12/1 + T15/1 offers various options of its parking position. Cord wrap and parking position.

## Maintenance and care

daily

weekly

Kärcher Customer Service

### 1

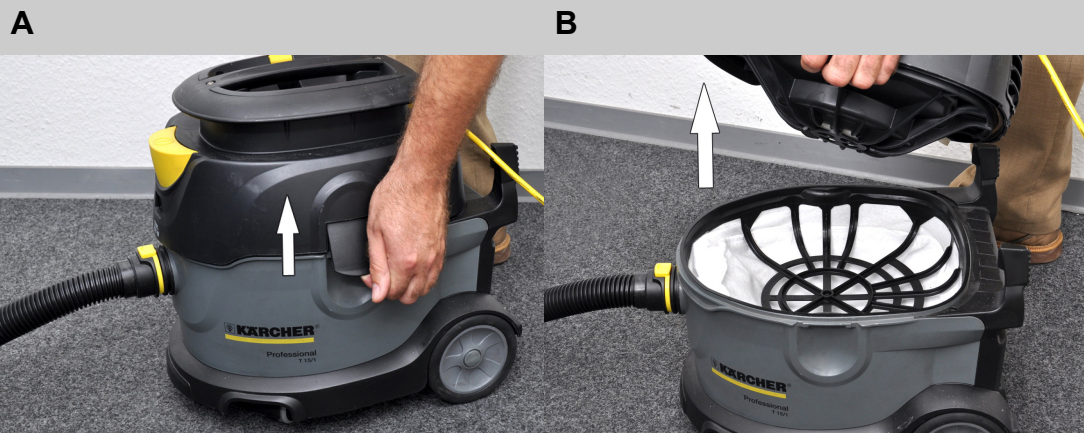

A Release and remove the suction head.

### 2

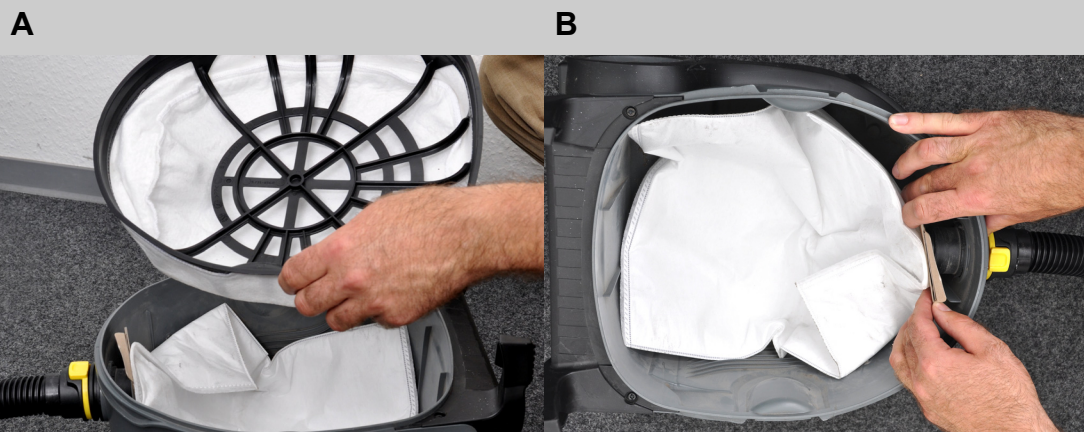

A Remove the main filter basket.  
B Replace the fleece filter bag or paper filter bag (option).

### 3

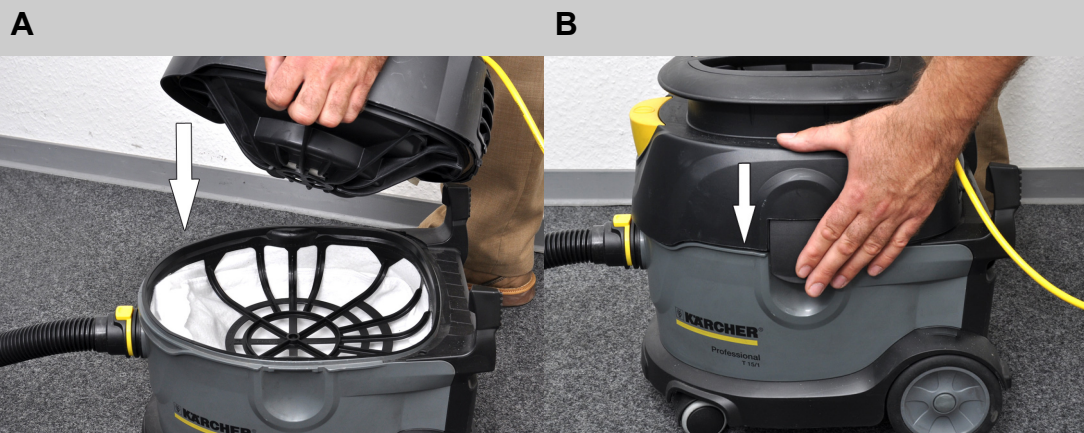

A Insert main filter basket.  
B Insert and lock the suction head.